

THIS DRAWING IS UNPUBLISHED. RELEASED FOR PUBLICATION  
 © COPYRIGHT BY TYCO ELECTRONICS CORPORATION. ALL RIGHTS RESERVED.

| LOC | DIST | REVISIONS   |                          |         |       |
|-----|------|-------------|--------------------------|---------|-------|
| P   | LTR  | DESCRIPTION | DATE                     | DWN     | APVD  |
| G   | 86   | L           | REDRAWN PER 0G3A-0395-04 | 02JUN04 | JR MS |

- 1 TONGUE MATERIAL THICKNESS .040±.003
- △ 2 BODY: COPPER PER ASTM B-152  
TIN PER ASTM B-545  
INSULATION: PVC, COLOR - RED  
METALLIC SLEEVE: COPPER PER ASTM B-152  
METALLIC BAND: STEEL PER ASTM A109
- 3 FOR .298 MAX WIRE INSULATION DIA

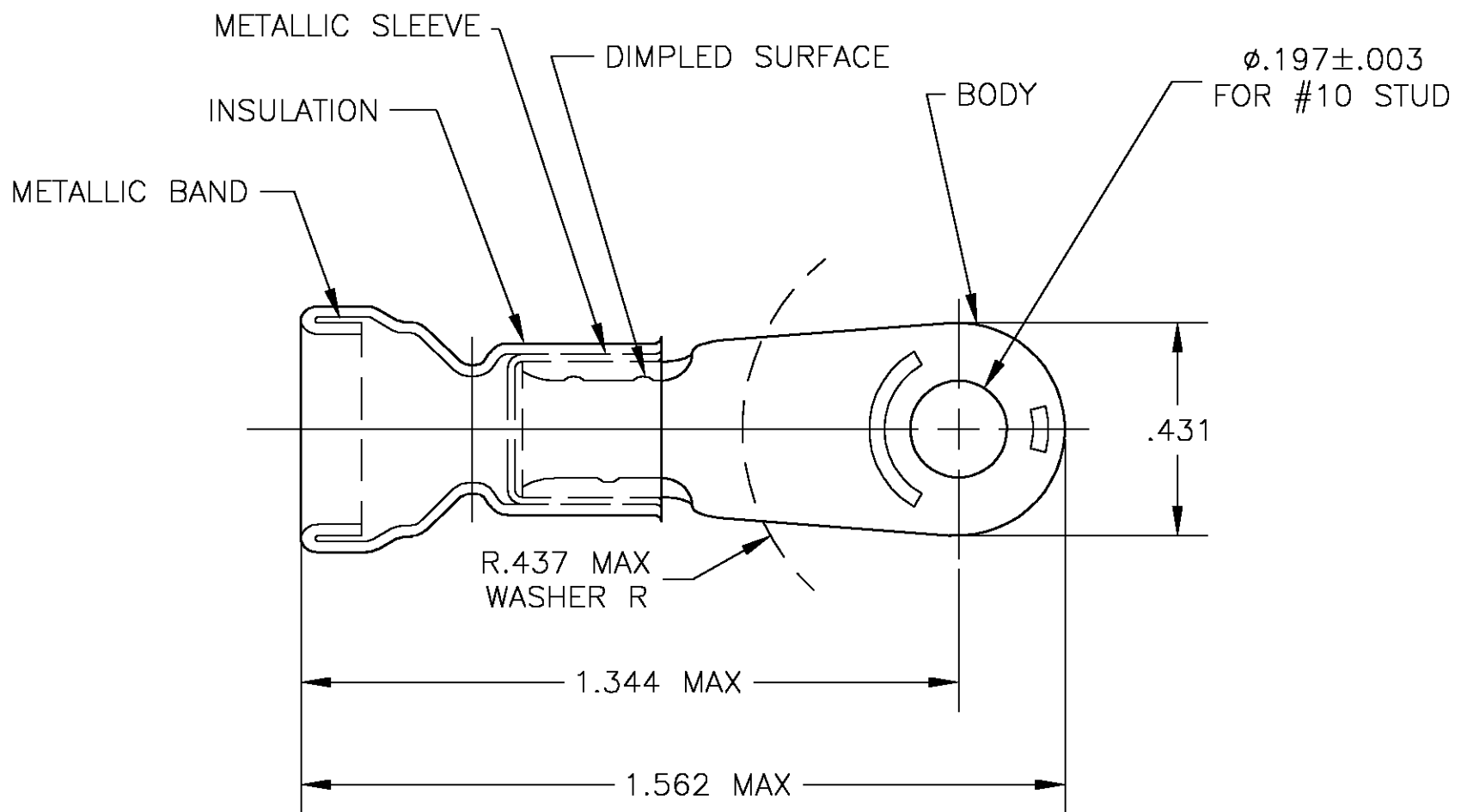

|                 |     |               |         |
|-----------------|-----|---------------|---------|
| 2-322128-2      | 1   | WIRE TERMINAL | 322128  |
| PART NO ON TAPE | QTY | DESCRIPTION   | PART NO |

|  |  |                              |   |           |
|--|--|------------------------------|---|-----------|
| THIS DRAWING IS A CONTROLLED DOCUMENT. |  | DWN<br>jr_ruth<br>02JUN04    | Tyco Electronics Corporation<br>Harrisburg, PA 17105      |           |
| DIMENSIONS:<br>INCHES                  |  | CHK<br>MJ SPICER<br>02JUN04  |   |           |
|  |  | APVD<br>MJ SPICER<br>02JUN04 | NAME<br>TERMINAL, AMPLI-BOND, RING TONGUE<br>WIRE SIZE: 8 |           |
| TOLERANCES UNLESS OTHERWISE SPECIFIED: |  | PRODUCT SPEC                 | RESTRICTED TO   |           |
| 0 PLC ± -                              |  | APPLICATION SPEC             | SIZE  | CAGE CODE |
| 1 PLC ± -                              |  | WEIGHT                       | A3  | 00779     |
| 2 PLC ± -                              |  | DRAWING NO                   |   | 322128    |
| 3 PLC ± .008                           |  | CUSTOMER DRAWING             |   |           |
| 4 PLC ± -                              |  | SCALE                        | SHEET   | OF        |
| ANGLES ± 5°                            |  | 3:1                          | 1   | 1         |
| FINISH                                 |  | REV                          | L   |           |
| - △ 2                                  |  |                              |   |           |